

1. Bài 1

Questions 1-5

Circle the appropriate letter.

Example

What has the woman lost?

A(answer)a briefcase

B a suitcase

C a handbag

D a wallet

- 1 What does her briefcase look like?



A



B



C



D

- 2 Which picture shows the distinguishing features?



A



B



C



D

- 3 What did she have inside her briefcase?

A wallet, pens and novel

B papers and wallet

C pens and novel

D papers, pens and novel

- 4 Where was she standing when she lost her briefcase?

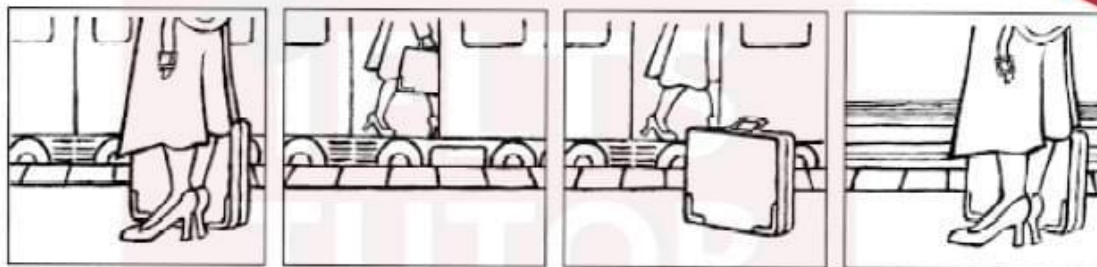

A

B

C

D

- 5 What time was it when she lost her briefcase?



A



B



C



D

Complete the form. Write NO MORE THAN THREE WORDS for each answer.

Questions 6-10

PERSONAL DETAILS FORM

Name: Mary (6)

Address: (7) (8) Road

Telephone: (9)

Estimated value of lost item: (10) £

2. Bài 2

Complete the notes. Use **NO MORE THAN THREE WORDS** for each answer.

KATE

Her first impressions of the town. *Example: Quiet*

Type of accommodation 1

Her feelings about the accommodation 2

Her feelings about the other students 3

Name of course: *Environmental Studies*

Difficulties experienced on the course 4

Suggestions for improving the course 5

LUKI

First type of accommodation 6

Problem with the first accommodation 7

Second type of accommodation 8

Name of course 9

Comments about the course: *Computer room busy*

Suggestions for improving the course 10

3. Bài 3

Questions 1-4

Circle the appropriate letter.

Example: How does the woman travel every day?

- A by car
- B by bus
- C on foot
- D by train

1. What are the parking regulations on campus?

- A. undergraduate parking allowed
- B. postgraduate parking allowed
- C. staff parking only allowed
- D. no student parking allowed

2. The administration office is in

- A. Block B
- B. Block D
- C. Block E
- D. Block G

3. If you do not have a parking sticker, the following action will be taken:

- A. wheel clamp your car
- B. fine only
- C. tow away your car and fine
- D. tow away your car only

4. Which picture shows the correct location of the Administration office?

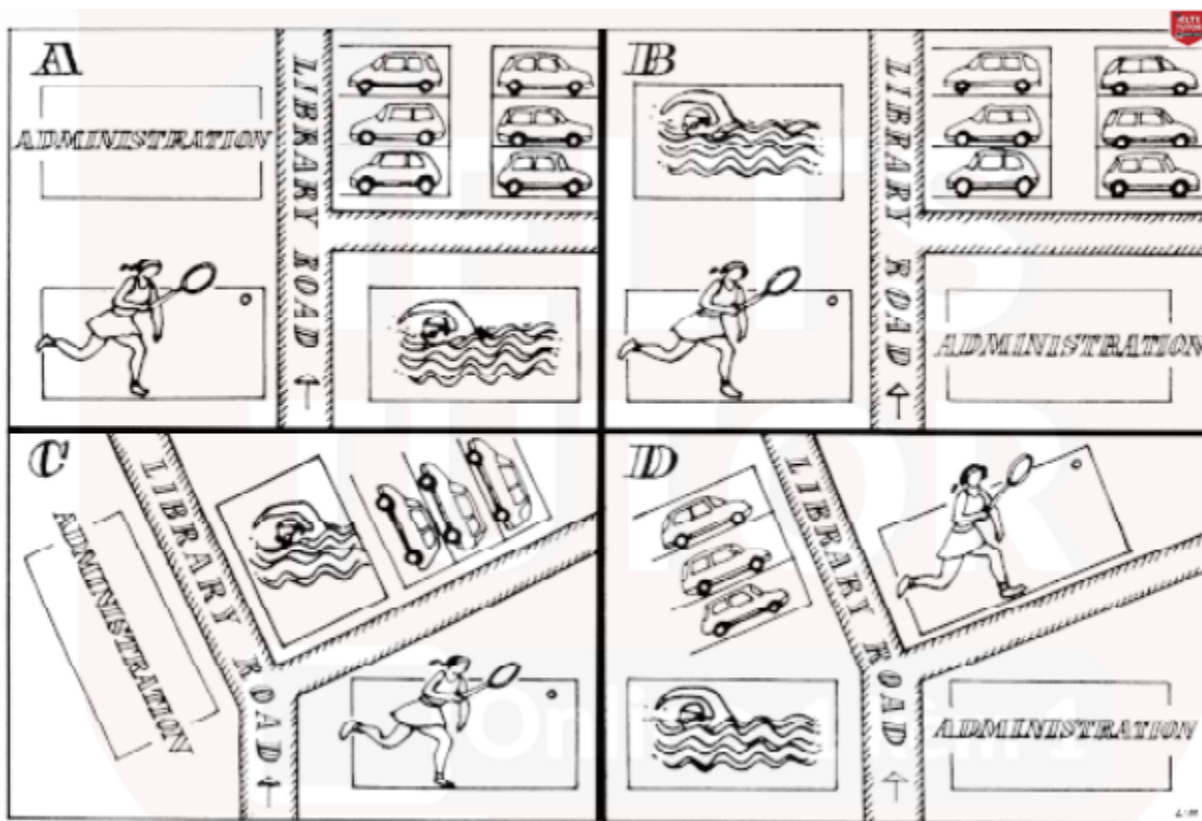

Questions 5-10

Complete the application form using NO MORE THAN THREE WORDS.

Application for parking sticker

Name (5)

Address (6) Flat 13

Suburb (7)

Faculty (8)

Registration number (9)

Make of car (10)

Questions 11-12

11. Cashier's office opens at: A 12.15 B 2.00 C 2.15 D 4.30

12. Where must the sticker be displayed?

4. Bài 4

Questions 1-5

Circle the appropriate letter.

Example: What are the students looking for?

A (answer) Main Hall

B Great Hall

C Old Hall

D Old Building

1. Where is the administration building?

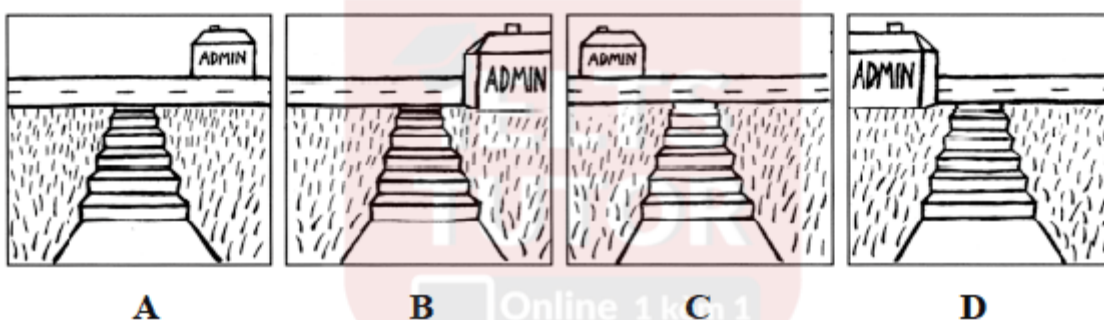

2. How many people are waiting in the queue?

A 50 B 100 C 200 D 300

3. What does the woman order for lunch?

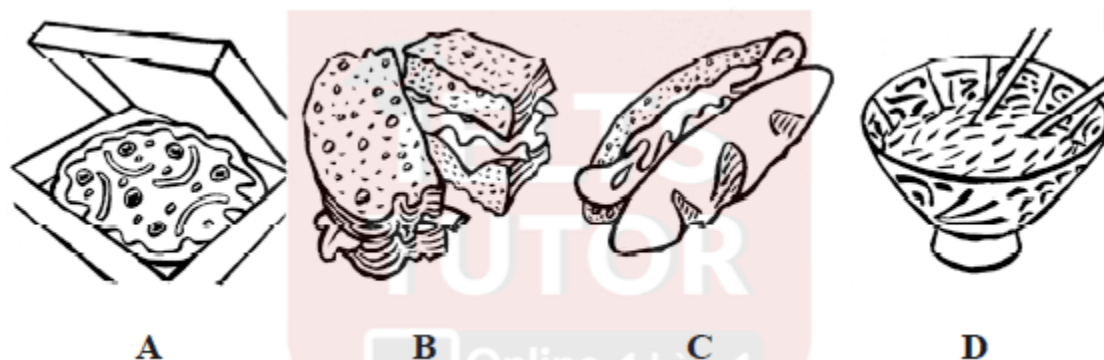

4. What does the woman order to drink?



A



B



C



D

5. How much money does the woman give the man?

A \$2.00 B \$3.00 C \$3.50 D \$5.00

Questions 6 - 10

Complete the registration form using NO MORE THAN THREE WORDS.

Name of student: (6)

Address: (7) Flat 5/

Town: (8)

Tel: (9)

Course: (10)

Questions 11 – 12

11. What did the man buy for her to eat?



A



B



C



D

12. What must the students do as part of registration at the university?

A Check the notice board in the Law Faculty

B Find out about lectures

C Organise tutorial groups

D Pay the union fees

5. Bài 5

Questions 1-5

Complete the form below. Write **NO MORE THAN ONE WORD OR A NUMBER** for each answer.

VIDEO LIBRARY APPLICATION FORM

EXAMPLE

Surname Jones

First names: Louise Cynthia

Address: Apartment 1, 72 (1) Street Highbridge

Postcode: (2)

Telephone: 9835 6712 (home)

(3) (work)

Driver's licence number: (4)

Date of Birth: Day: 25th Month: (5) Year: 1977

Questions 6-8

Write **THREE** letters A-F.

What types of films does Louise like?

A Action

B Comedies

C Musicals

D Romance

E Westerns

F Wildlife

Questions 9 and 10

Write **NO MORE THAN 3 WORDS** for each answer.

9. How much does it cost to join the library?

10. When will Louise's card be ready?

6. Bài 6

Questions 1 and 2

Circle the correct letters A-C.

Example...

Gavin moved into his apartment...

A two days ago.

(B) two weeks ago.

C two months ago.

1. Gavin's apartment is located on the ...

A ground floor.

B second floor.

C third floor.

2. The monthly rent for Gavin's apartment is ...

A \$615.

B \$650.

C \$655.

Questions 3-6

Complete the table below. Write NO MORE THAN THREE WORDS for each answer.

ITEM VALUE	
(3).....	\$450
(4).....	\$1,150
Watches	\$2,000
CDs and (5).....	\$400
.....	
Total annual cost of insurance (6) \$.....	

Questions 7 - 10

Complete the form below. WRITE NO MORE THAN THREE WORDS for each answer.

INSURANCE APPLICATION FORM

Name: Mr Gavin (7)

Address: (8)..... Biggins Street

(9).....

Date of Birth: 12th November

Telephone: Home: 9872 4555

Nationality: (10).....

7. Bài 7

Questions 1- 4

Circle the correct letters A-C.

Example: The respondent is...

A 20-33 years old

(B) 34-54 years old

C over 54 years old

1. The respondent works in...

A the professions.

B business.

C other.

2. The respondent has a salary of...

A 0 - £15,000 a year.

B £15,000 - £35,000 a year.

C over £35,000 a year.

3. The respondent watches TV for...

A relaxation.

B entertainment.

C information.

4. Every day the respondent watches TV for...

A 30 minutes-1 hour.

B 1 hour - 2 hours.

C more than 2 hours.

Questions 5-7: Choose two letters A-E for questions, 5-7.

5. The respondent mainly watches TV...

A in the early morning.

B around midday.

C in the afternoon.

D in the early evening.

E at night.

6. On the new channel, the respondent would like to see more...

- A children's programmes.
- B documentaries.
- C local service programmes.
- D travel programmes.
- E health programmes.

7. The respondent would advise the new channel to...

- A spend more money on drama.
- B train their broadcasters to higher standards.
- C improve sound [quality](#).
- D broadcast interviews with famous people.
- E talk more to customers.

Questions 8-10

Circle the correct letters A-C.

8. The respondent feels that adverts should occur every...

- A 10 minutes.
- B 15 minutes.
- C 20 minutes.

9. The respondent would like to attend special promotions if...

- A expenses are paid.
- B he is invited specially.
- C they are held locally.

10. The respondent would like to receive...

- A no mail.
- B requested mail.
- C all mail.

8. Bài 8

Questions 1 and 2:

Complete the notes below. Write NO MORE THAN THREE WORDS for each answer.

MIC HOUSE AGENCY — REPAIRS	
Address: Apartment 2, (1)	Newton.
Length of lease: one year.	
Date moved in: (2)	

Questions 3-9

Complete the table below. Write:

A if the repair will be done immediately.

B if the repair will be done during the following week.

C if the repair will be done in two or more weeks.

Item	Problem	When to be done
washing machine	leaking	
cooker	(3)	(4)
windows	(5)	B
(6)	flickers	(7)
(8)	torn	(9)

Question 10:

Write NO MORE THAN THREE WORDS or A NUMBER for each answer.

Workman to call <u>between</u> (10)..... and
--

9. Bài 9

Questions 1-10

Complete the notes below.

Name of agent: Flagstone

Areas dealt with: (1) north suburbs

Rent: from (2) £..... to £..... a month

Depends on:

- the [area](#)
- availability of (3)
- garage

Properties available:

- West Park Road
- rent (4) £..... a month
- including (5)
- Tithe Road
- rent £380 a month
- including (6) rental

Viewing arrangements: meet at office on (7) at 5.00 pm

Need:

- letter from bank
- [reference](#) from (8)

Must:

- give (9) notice of moving in
- give deposit of (10)
- pay for contract

10. Bài 10

Questions 1-5

Complete the table below. Write NO MORE THAN THREE WORDS OR A NUMBER for each answer.

Programme of Activities for First Day		
Time	Place	Event
<i>Example</i> 10.00	1	Meet the Principal and staff
10.15		Talk by 2
10.45		Talk by 3
4	Classroom 5	5 test

Questions 6-10

Label the rooms on the map below. Choose your answers from the box below and write them next to questions 6-10.

CL Computer Laboratory

DO Director's Office

L [Library](#)

MH Main Hall

S Storeroom

SAR Self [Access](#) Room

SCR Student Common Room

SR Staff Room

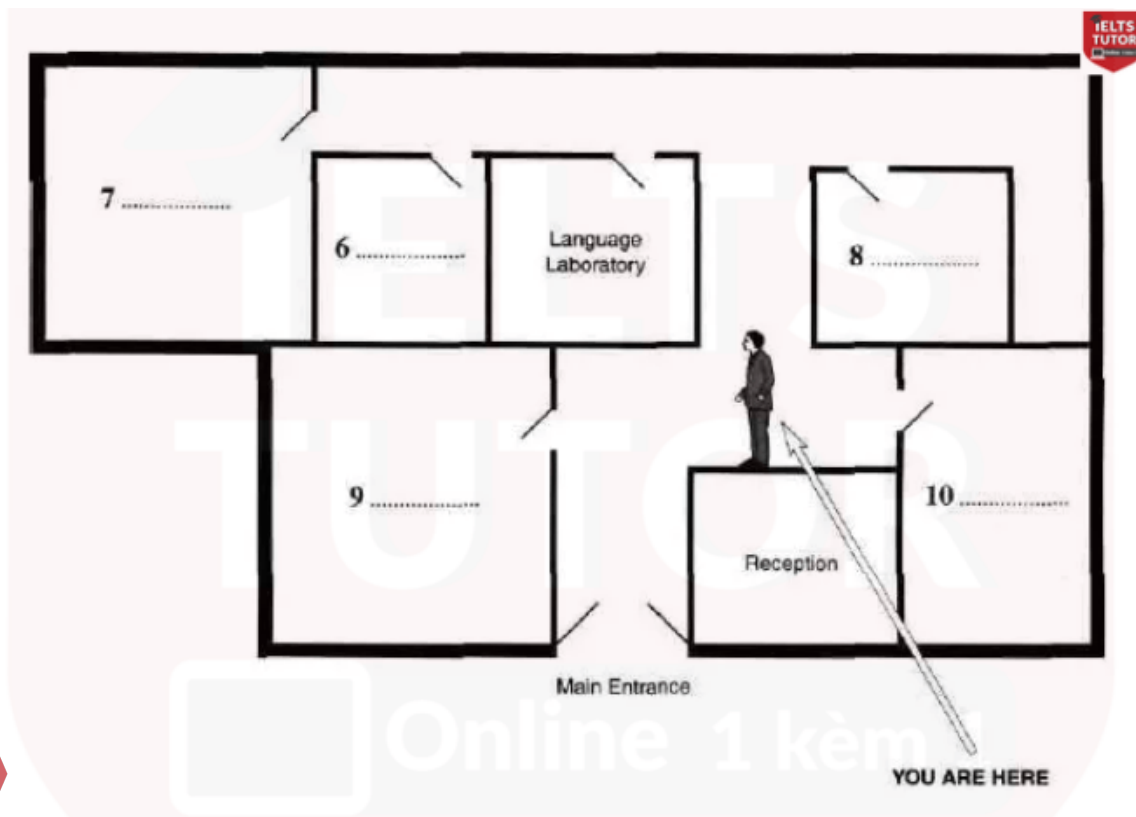

11. Bài 11

Questions 1 - 10

Complete the notes below. Write **NO MORE THAN THREE WORDS AND/OR A NUMBER** for each answer.

NOTES – Christmas Dinner

Example: Number to book for

Answer: ...45...

Date of Dinner: 21 December

Choices for venue:

- First choice → (1) Tel. number: not known
- Second choice → (2) Tel. number: 777192
- Third choice → (3) Tel. number: (4)

Price per person: £12

Restaurant must have: vegetarian food and a (5)

Menu:

First course – French Onion Soup OR Fruit Juice

Main course – Roast Dinner OR (6)

Dessert – Plum Pudding OR Apple Pie

Restaurant requires from us:

(7) and letter of confirmation

and we must (8) in advance.

Must confirm in writing by: (9)

Put notice in (10)

12. Bài 12

Questions 1 - 2

Complete the form below. Write **NO MORE THAN THREE WORDS AND/OR A NUMBER** for each answer.

Birth Statistics

Example: Date of birth: 10 August

Sex: male

First name: Tom

Surname: Lightfoot

Weight: (1) Kgs

Length: 2) Cms

Colour of hair: black

Questions 3 - 5

Label the map. Choose your answers from the box below. Write the appropriate letters A-E.

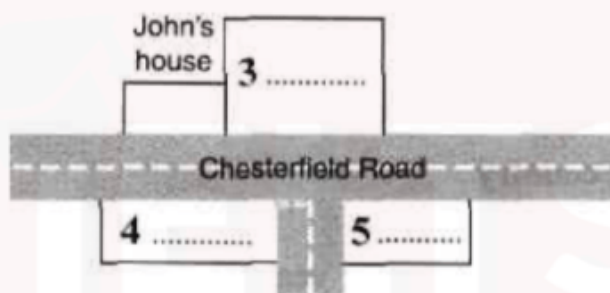

- A State Bank
- B St George's Hospital
- C Garage
- D Library
- E University

Questions 6 - 10

Write NO MORE THAN THREE WORDS OR A NUMBER for each answer.

	Gift for Susan	Gift for baby
What will they buy?	(6)	(7)
Where will they buy the gifts?	(8)	(9)
Approx. prices?	\$15	(10) \$.....

13. Bài 13

Questions 1–4

Complete the notes below. Write **NO MORE THAN THREE WORDS AND/OR A NUMBER** for each answer.

NOTES ON SOCIAL PROGRAMME

Example: Number of trips per month. Answer: 5

Visit places which have:

- historical interest
- good 1
- 2

Cost: between 5.00 pounds and 15.00 pounds per person

Note: special trips organised for groups of 3..... people

Time:

- departure – 8.30 a.m.
- return – 6.00 p.m.

To reserve a seat: sign name on the 4..... 3 days in advance.

Questions 5 – 10: Complete the table below. Write **NO MORE THAN THREE WORDS AND/OR A NUMBER** for each answer.

WEEKEND TRIPS			
Place	Date	Number of seats	Optional extra
St Ives	5	16	Hepworth Museum
London	16th February	45	6
7	3rd March	18	S.S. Great Britain
Salisbury	18th March	50	Stonehenge
Bath	23rd March	16	8
For further information: Read the 9 or see Social Assistant: Jane 10			

14. Bài 14

Questions 1–5

Choose the correct letter, A, B or C.

Example

How long has Sally been waiting?

- A five minutes
- B twenty minutes
- C thirty minutes

1 What does Peter want to drink?

- A tea
- B coffee
- C a cold drink

2 What caused Peter problems at the bank?

- A The exchange rate was down.
- B He was late.
- C The computers weren't working.

3 Who did Peter talk to at the bank?

- A an old friend
- B an American man
- C a German man

4 Henry gave Peter a map of

- A the city.
- B the bus routes.
- C the train system.

5 What do Peter and Sally decide to order?

- A food and drinks
- B just food
- C just drinks

Questions 6–8

Complete the notes below using words from the box.

Art Gallery

Cathedral

Castle

Gardens

Markets

Tourist attractions open all day: **6** _____ and Gardens

Tourist attractions NOT open on Mondays: **7** _____ and Castle

Tourist attractions which have free entry: **8** _____ and Markets

Questions 9 and 10

Complete the sentences below. Write **NO MORE THAN THREE WORDS** for each answer.

9 The first place Peter and Sally will visit is the _____.

10 At the Cathedral, Peter really wants to _____.

15. Bài 15

Question 1-4

Complete the form below. Write *NO MORE THAN THREE WORDS AND/OR NUMBERS* for each answers.

Example Answer

Name: Sara Lim

Accommodation Request Form

Age: 23

Length of time in Australia; 1 _____

Present address: Flat 1, 539, 2 _____ Road Canterbury 2036

Present course: 3 _____ English

Accommodation required from: 4 _____ 7th September

Questions 5-7

Choose the correct letter, A, B or C.

5 Sara requires a

A single room.

B twin room.

C triple room.

6 She would prefer to live with a

A family.

B single person.

C couple.

7 She would like to live in a

A flat.

B house.

C studio apartment.

Questions 8-10

Complete the sentences below. Write **NO MORE THAN ONE WORD** for each answer.

8. The _____ will be \$320.
9. She needs to pay the rent by cash or cheque on a _____ basis.
10. She needs to pay her part of the _____ bill.

16. Bài 16

Questions 1 - 10

Complete the notes below. Write **NO MORE THAN THREE WORDS AND/OR A NUMBER** for each answer.

GOODBYE PARTY FOR JOHN

Example: Date: 22nd December

Venue: (1)

Invitations (Tony)

Who to invite:

- John and his wife
- Director
- the (2)
- all the teachers
- all the (3)

Date for sending invitations: (4)

Present (Lisa)

Collect money during the (5)

Suggested amount per person: (6) \$.....

Check prices for:

- CD players
- (7)
- coffee maker

Ask guests to bring:

- snacks
- (8)
- (9)

Ask student representative to prepare a (10)

17. Bài 17

Questions 1-4

Complete the form below, using **NO MORE THAN THREE WORDS AND/OR A NUMBER** for each answer.

Dreamtime travel agency	
Tour information	
Example: Holiday name: Whale Watch Experience	
Holiday length: 2 days	
Type of <u>transportation</u> :	1
Maximum group size:	2
Next tour date:	3
Hotel name:	4 The

Questions 5 and 6

Choose two letters A-E.

Which TWO things are included in the price of the tour?
A. fishing trip
B. guided bushwalk
C. reptile park entry
D. table tennis
E. tennis

Questions 7-10

Complete the sentences below, using **NO MORE THAN A WORD AND/OR A NUMBER** for each answer.

7. The tour costs \$.....
8. Bookings must be made no later than days in advance.
9. A deposit is <u>required</u> .
10. The customer's reference number is

18. Bài 18

Questions 1-10

Complete the form below, using **NO MORE THAN THREE WORDS AND/OR A NUMBER** for each answer.

LIBRARY INFORMATION

Example: Minimum joining age

Answer: 18 years

For registration, must take:

- two 1 and
- two forms of I.D. e.g. driving licence, 2

Cost to join per year (without current student card): 3 £

Number of items allowed (members of public): 4

Loan times: four weeks

Fines start at 5 £

Computers can be booked up to 6 hours in advance

Library holds most national papers, all 7, and magazines

Need 8 to use photocopier

Creative Writing class

- tutor is John 9
- held on 10 evenings

19. Bài 19

Questions 1-10: Complete the form below. Write NO MORE THAN THREE WORDS AND/OR A NUMBER for each answer.

MINTONS CAR MART CUSTOMER ENQUIRY

Example: Make: Lida

Engine size: 1

Model: Max

Type of gears: 2

Preferred colour: 3 blue

FINANCE

Customer wishes to arrange: 4

Part exchange? Yes

PERSONAL DETAILS

Name: Wendy 5

Title: 6

Address:

- 20, Green Banks
- 7.....
- Hampshire

Postcode: GU8 9EW

Contact number: 8 (for only) 0798257643

CURRENT CAR

Make: Conti

Model:

- Name 9.....
- Year: 1994

Mileage: maximum 70,000

Colour: metallic grey

Condition: 10

20. Bài 20

Questions 1-10

Complete the form below, using **NO MORE THAN THREE WORDS AND/OR A NUMBER** for each answer.

HOST FAMILY APPLICANT

Example: Name

Answer: Jenny Chan

Present address: Sea View Guest House, 1

Daytime phone number: 2237676

• [NB Best time to contact is 2]

Age: 19

Intended length of stay: 3

Occupation while in UK: student

General level of English: 4

Preferred location: in the 5

Special diet: 6

Other requirements:

- own facilities
- own television
- 7
- to be 8

Maximum price: 9 £ a week

Preferred starting date: 10

21. Bài 21

Questions 1-4

Complete the sentences below, using **NO MORE THAN TWO WORDS** for each answer.

Notes on sports club

Example:

Name of club: Flagstone

Facilities available: Golf

- 1
- 2

Classes available:

- Kick-boxing
- 3

Additional facility: 4.....(restaurant opening soon)

Questions 5-8

Choose the table below. Write **NO MORE THAN TWO NUMBERS** for each answer.

MEMBERSHIP SCHEMES

Type	Use of facilities	Cost of classes	Times	Joining fee	Annual subscription fee
GOLD	All	Free	Any time	£250
SILVER	All	£	From am to pm	£225	£300
BRONZE	Restricted	£3	from 10.30 to 3.30 weekdays only	£50	£

Questions 9-10

Complete the sentences below, using **ONE WORD ONLY** for each answer.

9. To join the centre, you need to book an instructor's

10. To book a trial session, speak to David (0458 95311).

22. Bài 22

Questions 1-5

Complete the sentences below, using **NO MORE THAN TWO WORDS AND/OR A NUMBER** for each answer.

CHILDREN'S ART AND CRAFT WORKSHOPS

Example

Workshops organised every: Saturday

Adults must accompany children under 1

Cost: £2.50

Workshops held in: Winter House, 2..... Street

Security device: must push the 3 to open door

Should leave car behind the 4

Book workshops by phoning the 5 (on 200765)

Questions 6-10

Choose the table below. Write **NO MORE THAN TWO WORDS** for each answer.

Next two workshops

Date	Workshop title	Children advised to wear	Please bring (if possible)
16/11	Building
23/11	(Nothing special)

23. Bài 23

Questions 1 - 10

Complete the form below. Write ONE WORD AND/OR A NUMBER for each answer.

OPENING A BANK ACCOUNT

Example

Application for a Current bank account

Type of current account: The 1 ' _____ ' account

Full name of applicant: Pieter Henes

Date of birth: 2 _____

Joint account holder(s): No

Current address: 3 _____ Exeter

Time at current address: 4 _____

Previous address: Rielsdorf 2, Utrecht, Holland

Telephone: work 5 _____ home 796431

Occupation: 6 _____

Identity (security): Name of his 7 _____ Siti

Opening sum: 8 € _____ to be transferred from Fransen Bank, Utrecht

Statements: Every 9 _____

Requests: Supply information about the bank's 10 _____ service.